

## Product Introduction

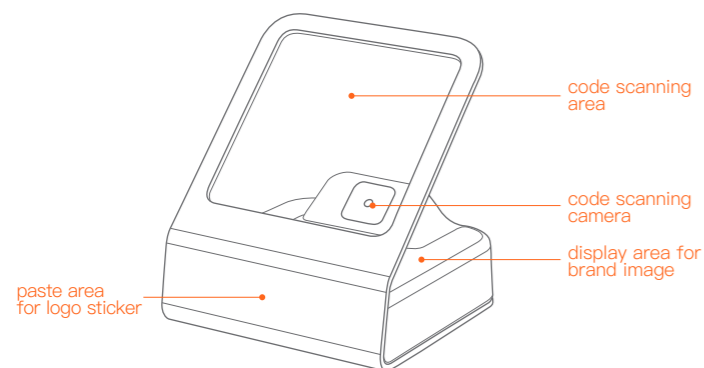

### Code scanning area

Place the mobile payment code within this area.

### Code scanning camera

Only supports reading the mobile payment code, and also supports 1D/2D quick code scanning.

### Paste area for logo sticker

You can paste the corresponding logo stickers according to type of payment.

### Display area for brand image

The merchants can display their brand images in this area.

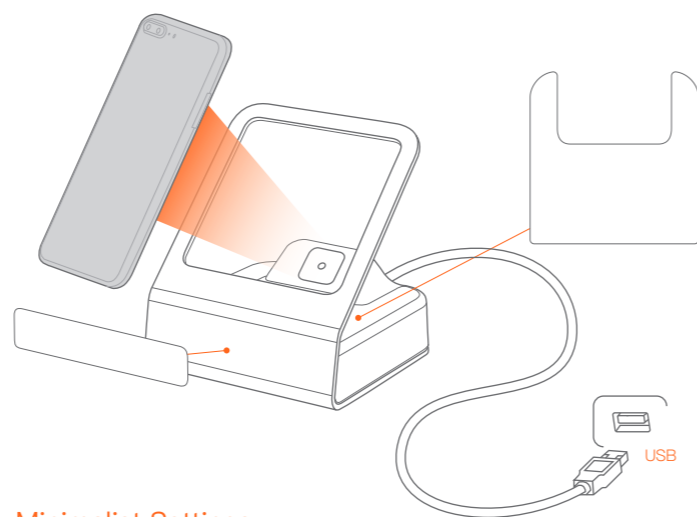

## Minimalist Settings

- 1.This device supports plug and play, and you can accomplish code scanning immediately whenever you connect any cash register. This product only supports scanning mobile payment code, not supporting bar code.
- 2.Please clean the code scanning camera in time when the scanning response is slow.

## Points for Attention

### Safety Warning

- Strictly forbidden to be applied at sites with any potentially explosive gas;
- As for non-professionals, please do not open the device at will in order to avoid risks;
- This is Grade A product. In the living environment, this product may cause radio interference. In this case, the user maybe required to apply feasible measures against the interference.

### Important Safety Instructions

- Avoid it to be installed or used during the thunder & lightning period, otherwise there will be risk of being electrically shocked by it;
- When you have discovered unusual odor, overheat or smog, please cut off the power supply at once.

### Suggestions

- Do not use it near water or in humid environment, to prevent liquid from dropping into the terminal;
- Do not use it in extreme cold or hot environment. For example: near the ignition source or lighted cigarette;
- Do not drop, throw or bend it;
- Try best to use it in clean and dust-free environment, to prevent small items from dropping into the terminal;
- Do not use it nearby the medical devices when not allowed.

### Statement

- Our company will not be responsible for the results of the following actions
- Damage caused by usage & maintenance not under the conditions of this guidance note;
  - Our company will not be responsible for any damage or problem caused by any option or consumable (not the initial product or recognized product provided by our company). You have no right to make product modifications or changes without the consent of our company;
  - The operating system of this product supports the official system update. If the user has flashed ROM system of third party or modified the system file by applying cracking method, it may lead to unstable system and bring safety risk and safety threat.

### Disclaimer

Due to the product update, certain details of this document may be inconsistent with the product. Please refer to the material item. Our company owns the interpretative right of this document. We reserve the right to modify this user guide without giving advance notice.

## Technical Indexes of the Product

Sensor	0.3 million CMOS sensor
Maximum frame number	30 FPS
Reading precision	2 D > 10 mil
Reading code system	Mobile QR code (2 D code), code 128 (1 D code)
Interface	USB
Input voltage	5 V/ 500 mA
Working current	Less than 190 mA
Sleep current	Less than 1 mA
Prompt	LED indication/buzzer
Supporting system	windows/ios/android/linux
Device size	9.7 x 9 x 10 cm
Code scanning window	7.5 x 7.5 cm
Working temperature	0°C-40°C
Working humidity	5%-95% (no condensation)
Storage temperature	-10°C-50°C

## Package Contents

- One host
- One piece of User Guide

## Name and content of toxic and harmful substances contained in this product are shown in the following table

Name of parts	Toxic and harmful substances and elements					
	(Pb)	(Hg)	(Cd)	(Cr(VI))	(PBB)	(PBDE)
Circuit board	×	○	○	○	○	○
Shell	○	○	○	○	○	○

○:It indicates that the content of toxic and harmful substances in all homogeneous materials of this part is below the limit specified in SJ/T11363-2006.

×:It indicates that the content of toxic and harmful substances is higher than the limit specified in SJ/T11363-2006 in at least one homogeneous material of this part; however, the the reason why the toxic substance of that part exceeds the limit is that there is no applicable material to replace it currently.

For products that have reached or passed the service years for environmental protection, they should be recycled according to Measures for Control and Management of Electronic Information Products and should not be thrown away at will.

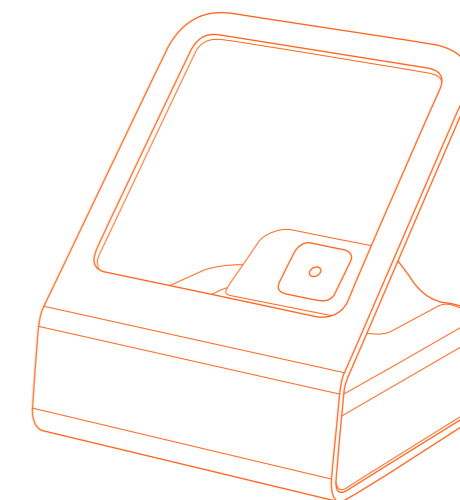

## User Guide

### Manufacture

Room 505 No.388 Song Hu Road Shanghai, China

封底

封面

PANTONE 165C  K

## 制作工艺说明

成品尺寸: 105mm × 105mm

展开尺寸: 419mm × 105mm

工艺: 1黑板+1专, 四折页

材质: 105g 雅粉纸